

4.1.1 The Institution has adequate infrastructure and physical facilities for teaching- learning. viz., classrooms, laboratories, computing equipment, ICT facilities Gymnasium etc.

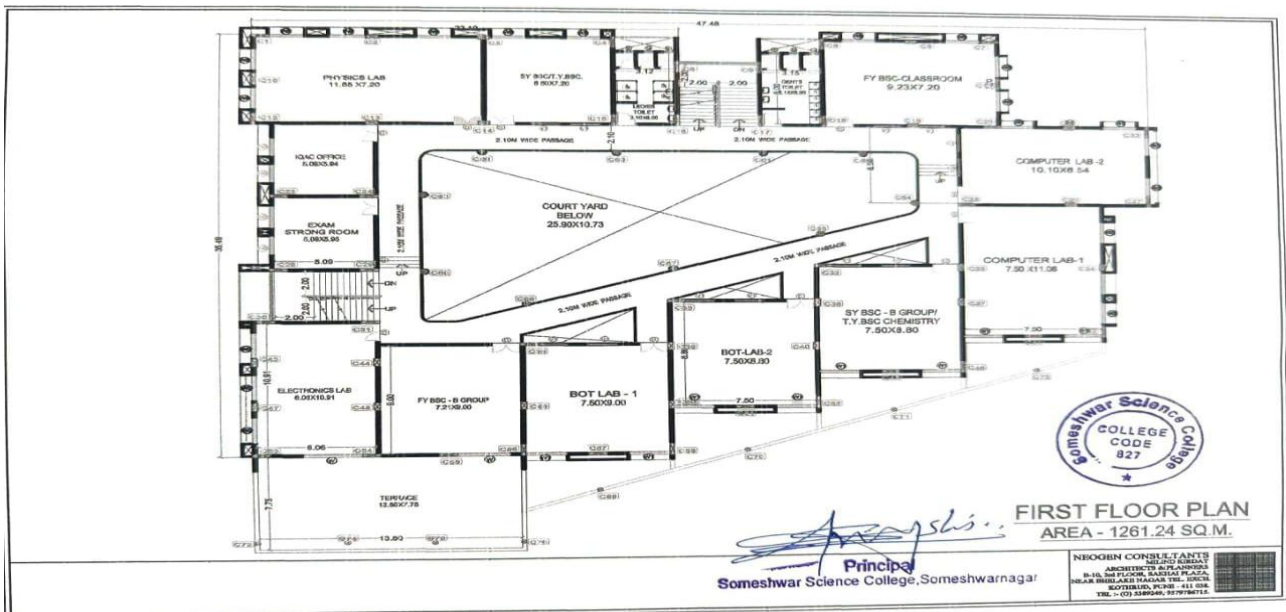

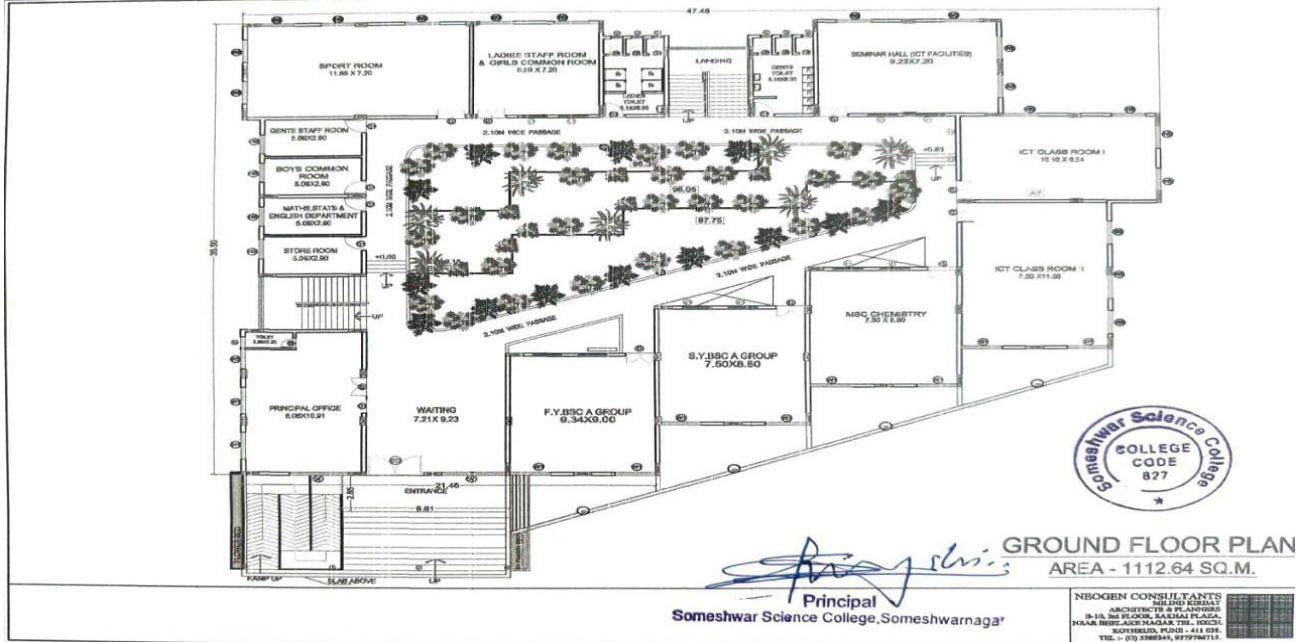

COLLEGE PREMISES



WATER TANK FOR COLLEGE

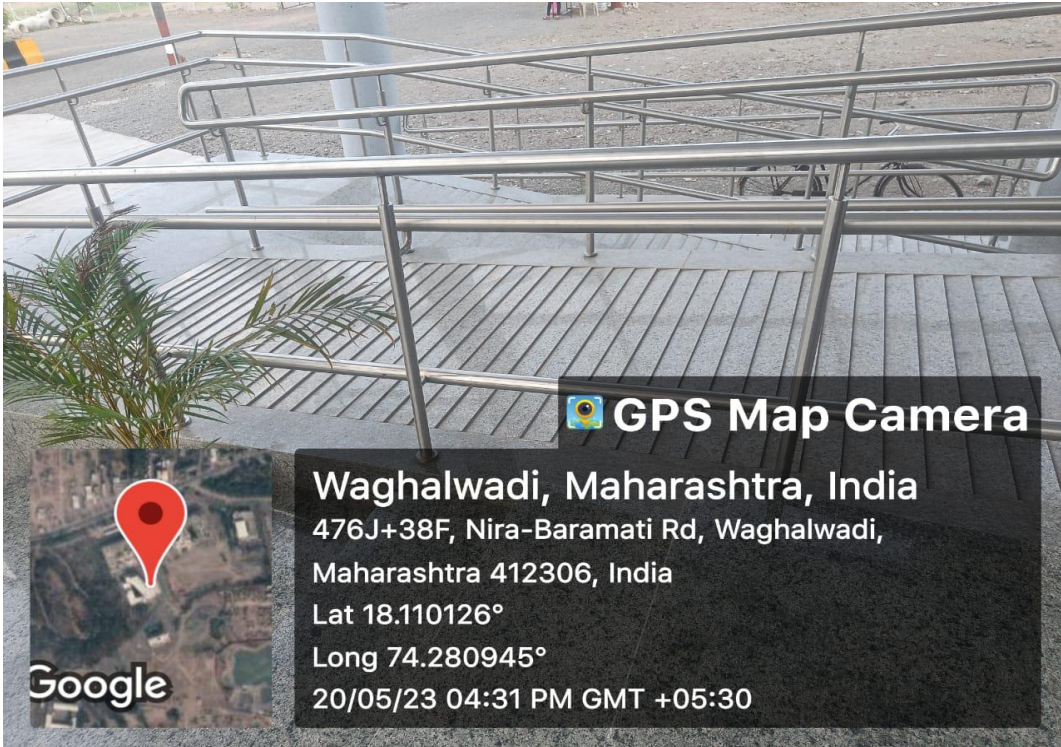

RAMP FOR DIVYANG



CCTV CAMERA



WiFi Router



RO Water Purifier



Bio-Metric System



Computer, Printer Plus Scanner at computer department

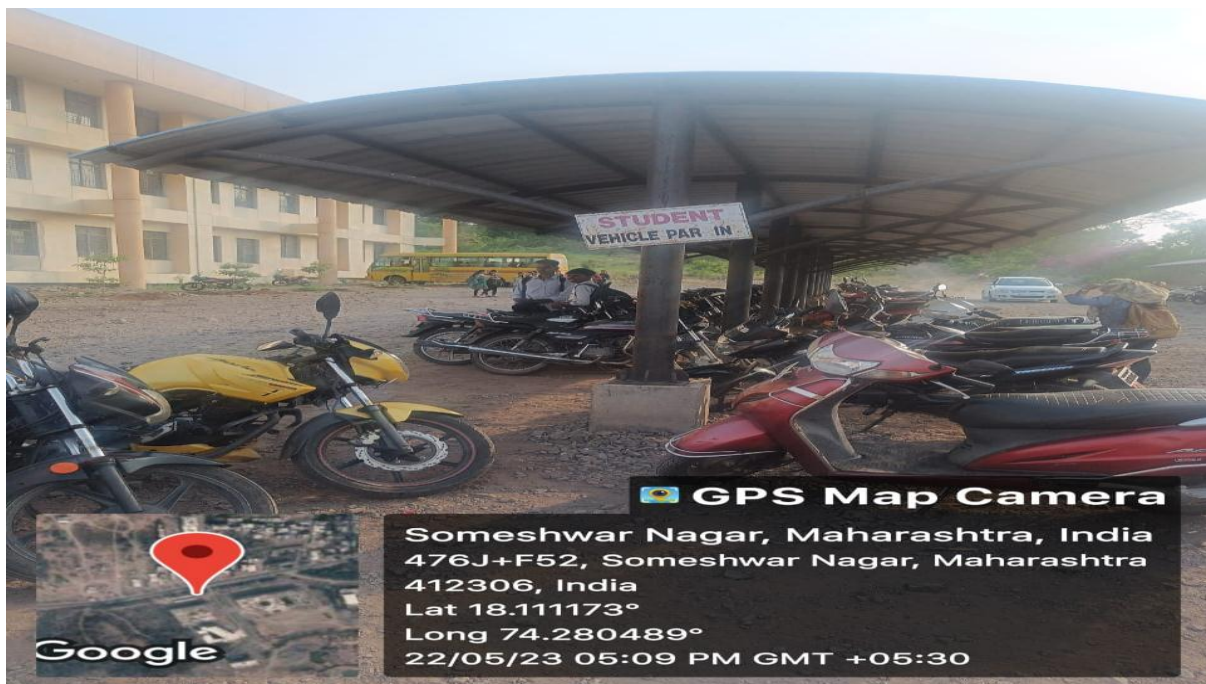

Parking of Vehical for Students



Parking of Vehical for Staff



Computer Lab



Chemistry Laboratory



Electronics Laboratory with Computer Plus Printer



Well Equipped Microbiology Laboratory



Zoology Laboratory



Botony Laboratory





Botanical Garden (1.5 Acre)







Girl's Section for reading At Library

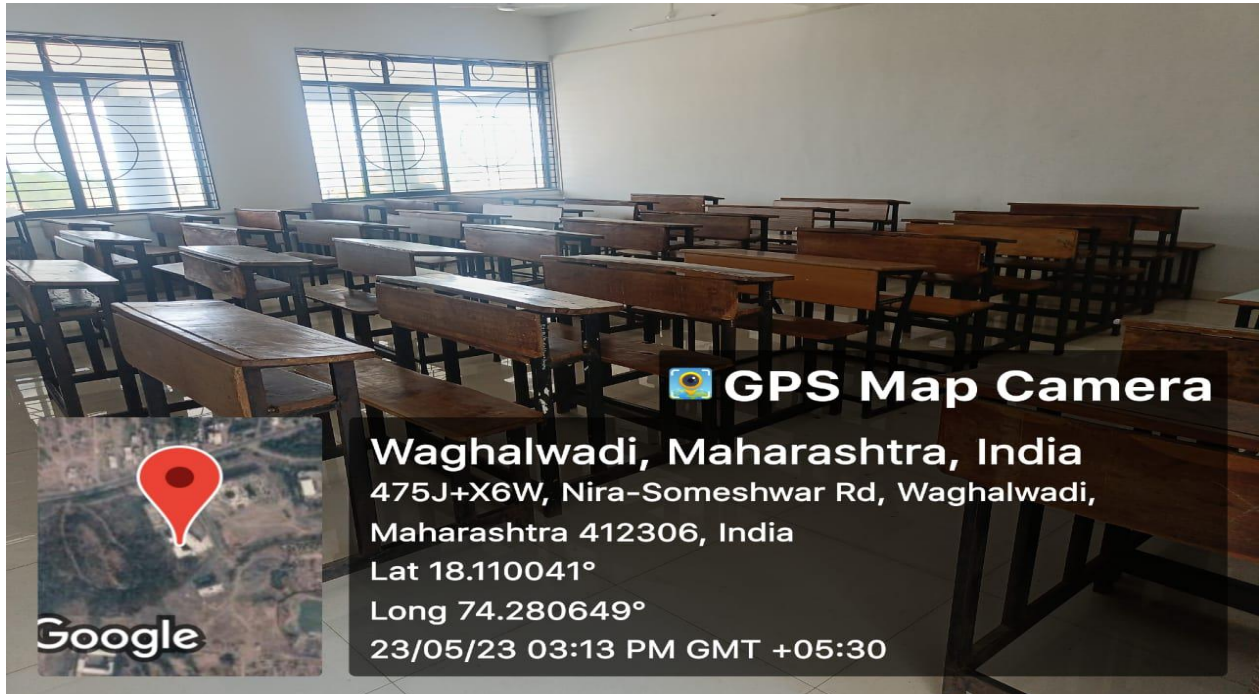

Boy's Section for Reading At Library



 **GPS Map Camera**



Waghalwadi, Maharashtra, India
475J+X6W, Nira-Someshwar Rd, Waghalwadi,
Maharashtra 412306, India
Lat 18.110041°
Long 74.280649°
23/05/23 03:13 PM GMT +05:30

Classrooms

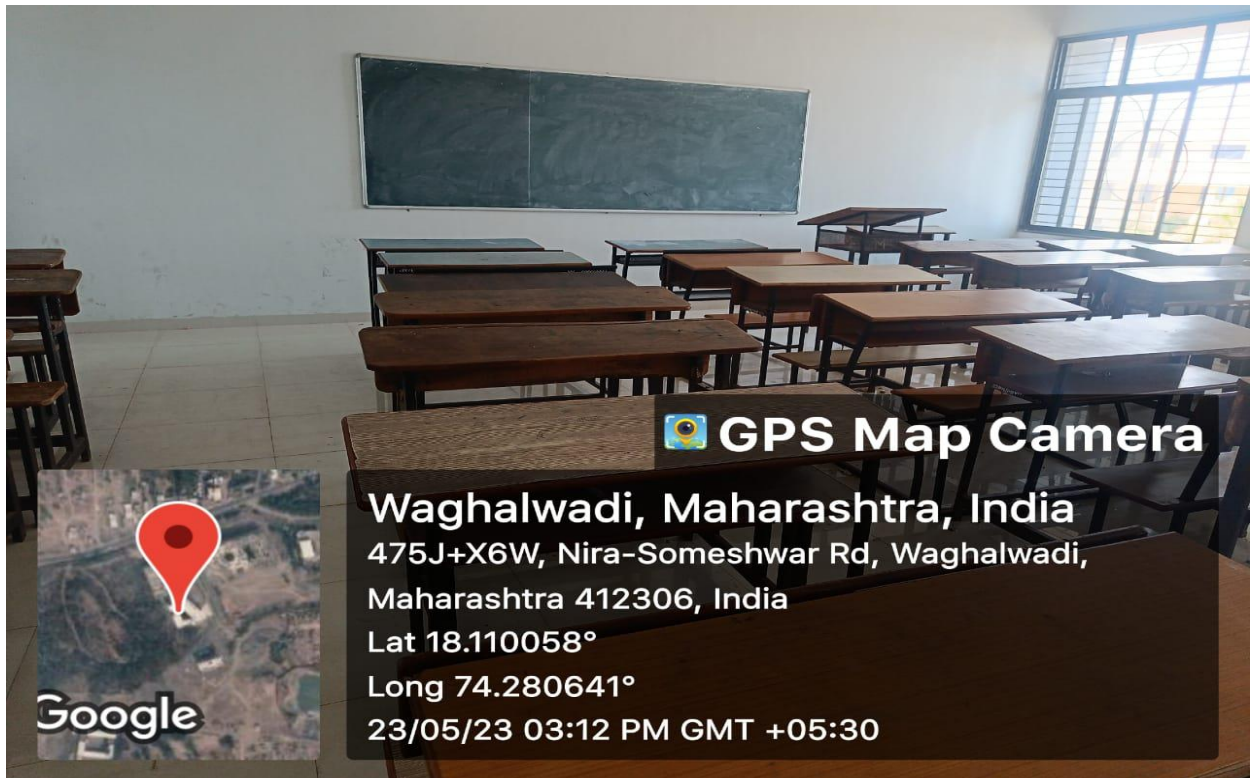

 **GPS Map Camera**



Waghalwadi, Maharashtra, India
475J+X6W, Nira-Someshwar Rd, Waghalwadi,
Maharashtra 412306, India
Lat 18.110058°
Long 74.280641°
23/05/23 03:12 PM GMT +05:30



ICT Facility WiFi, LAN Connection & LCD Projector



Xerox Machine For Exam Department

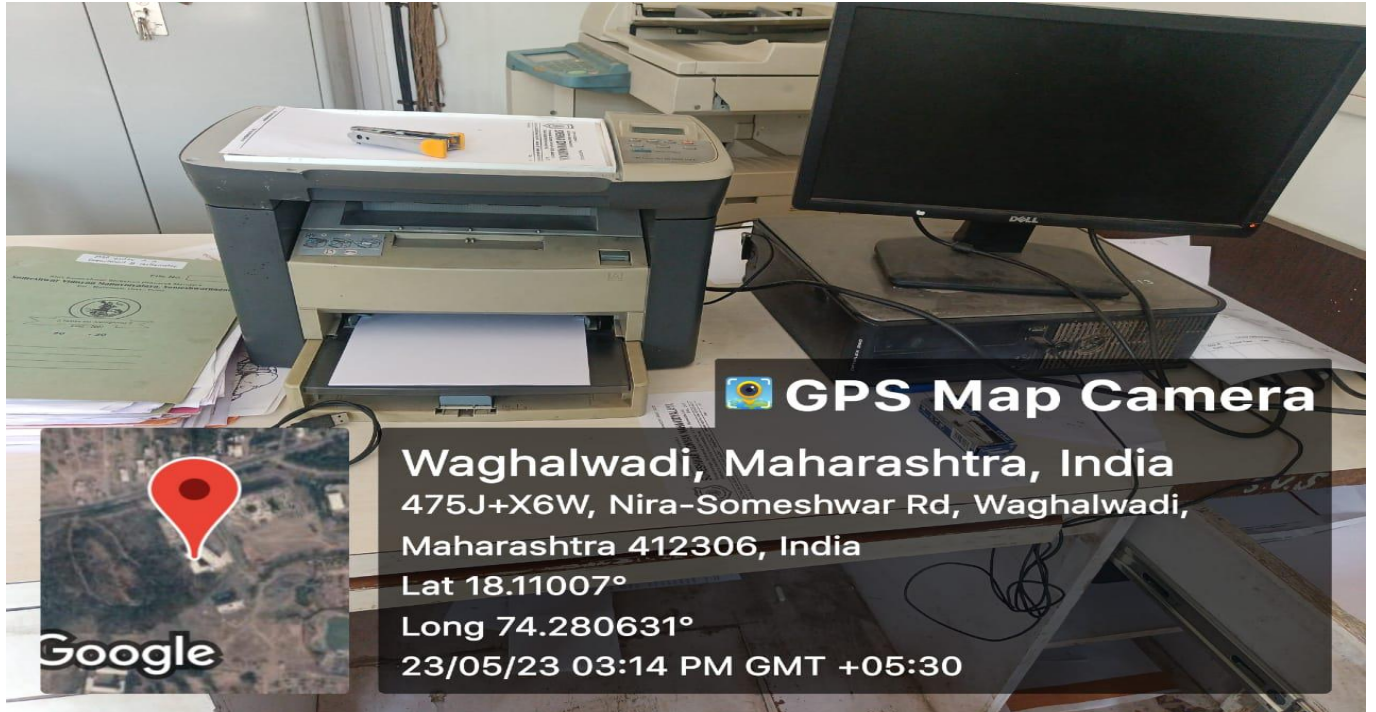

Computer Plus Printer For Exam Department



Computer Plus Printer for Administrative office



Canteen



Sanitary Napkin Incinerator At ground floor Ladies Washroom



Play Ground For Students



ABS Workout Machine



Yoga Facilities



Table Tennis



Carrom Board



Cultural Activities



Cultural Activities

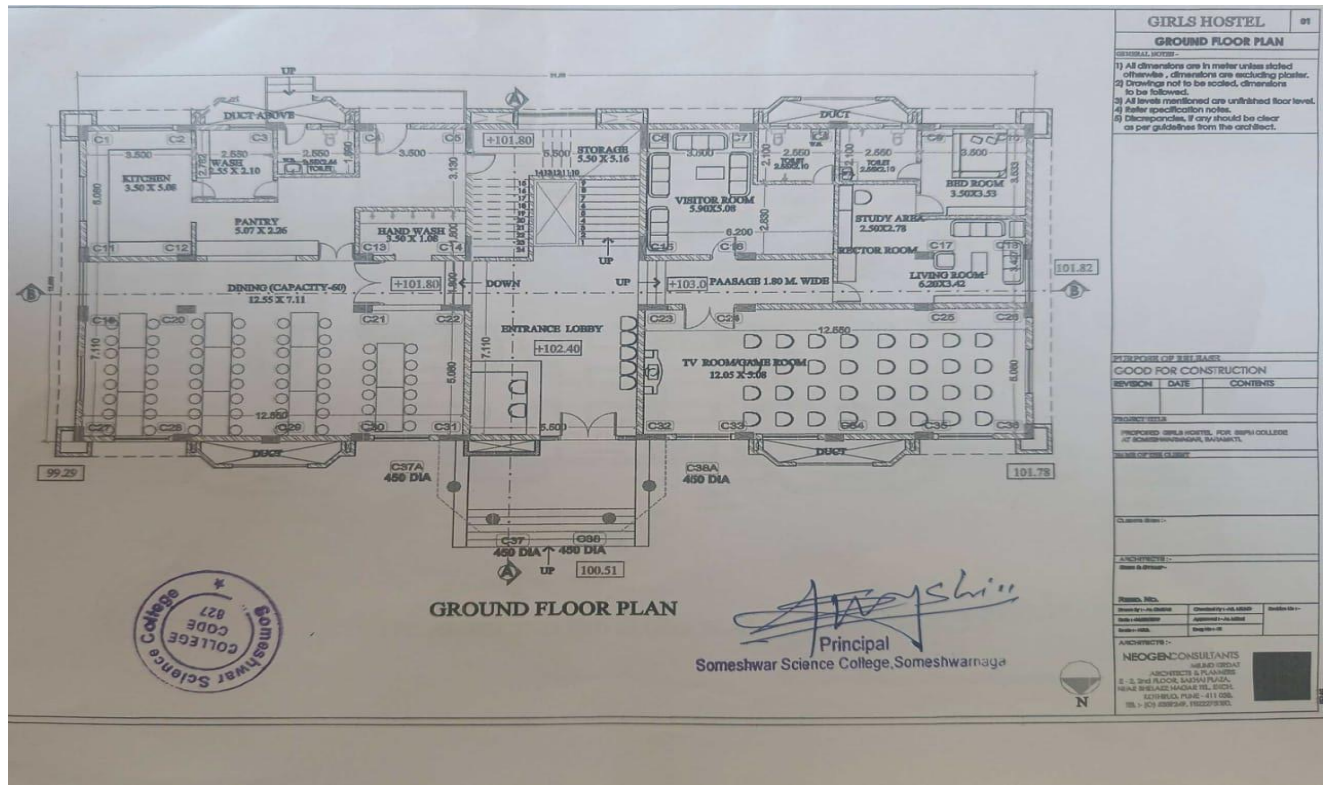

Girl's Hostel Building Plan

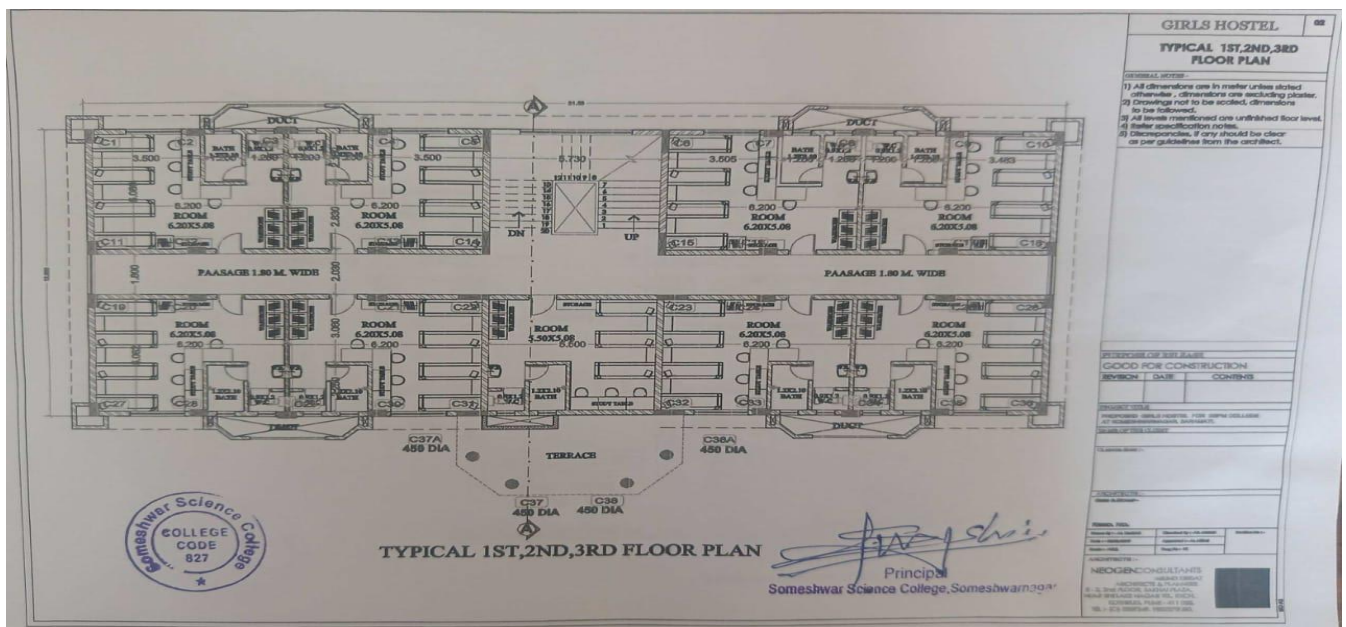



Girl's Hostel Building



Water Tank For Hostel (10,000 Litre Capacity)



Solar Pannel For Hostel



Dining Hall for Hostel

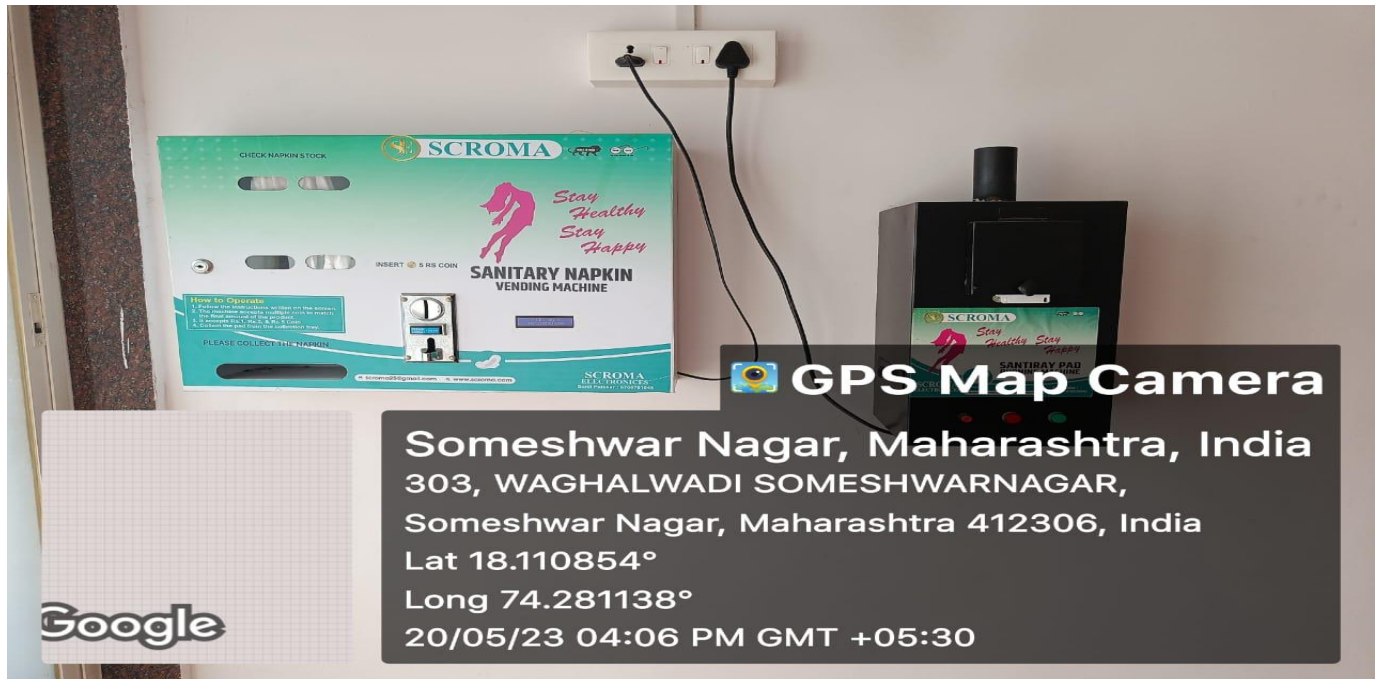

Sanitary Napkin Vending Machine at Girl's Hostel